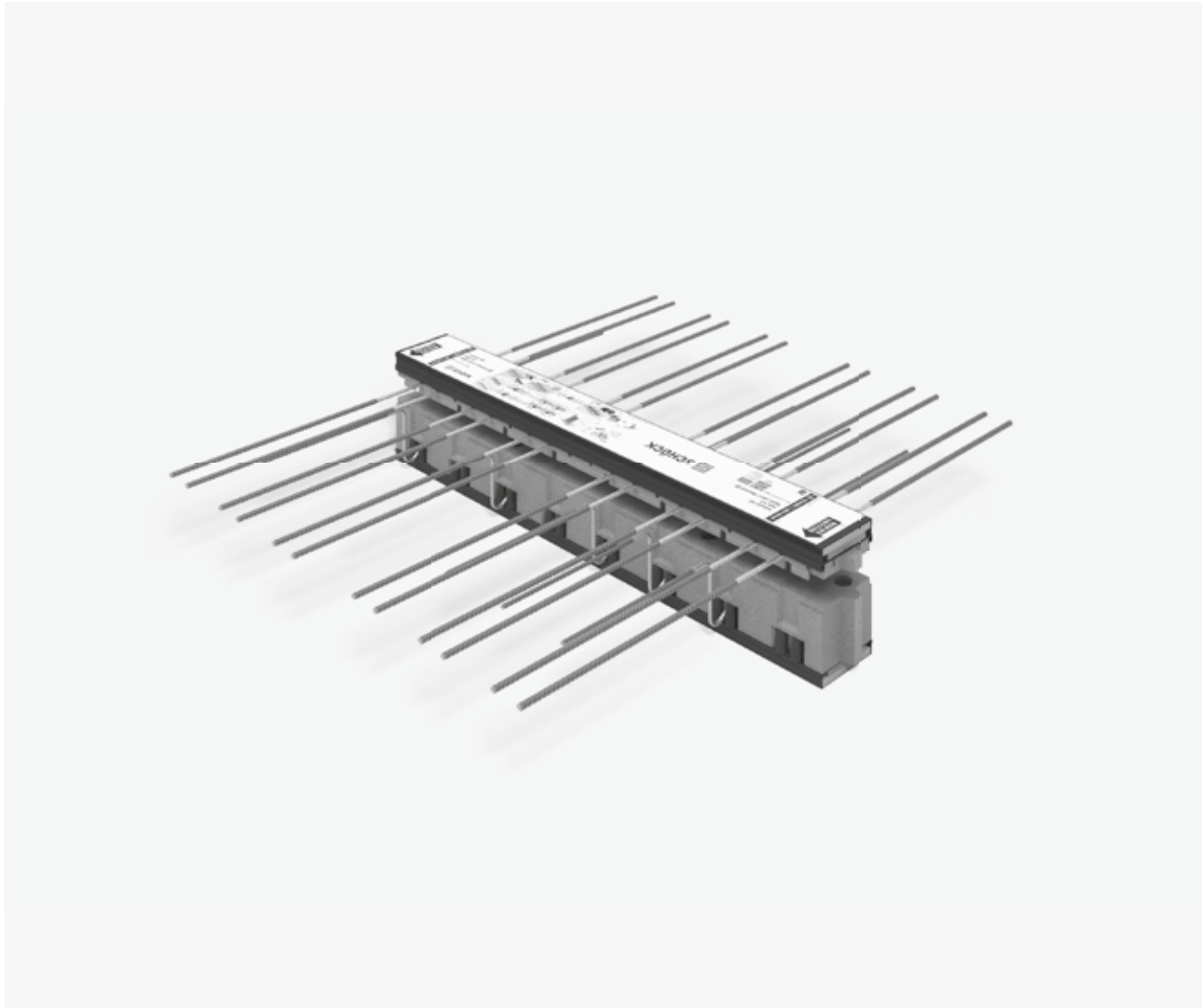

Schöck Isokorb® XT/T Typ K-F

XT/T
Typ K-F

Stahlbeton – Stahlbeton

Einbauanleitung – Fertigteilwerk

Typ K-F

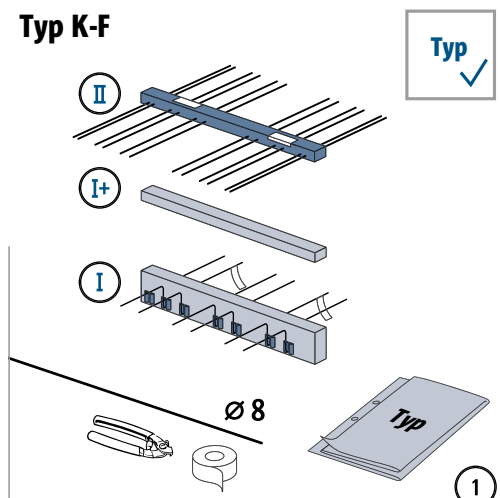

H	=	I	+	I+	+	II
160 mm	=	114	+	–	+	46
180 mm	=	114	+	20	+	46
190 mm	=	114	+	30	+	46
200 mm	=	114	+	40	+	46
⋮		⋮		⋮		⋮
250 mm	=	114	+	3 · 30	+	46

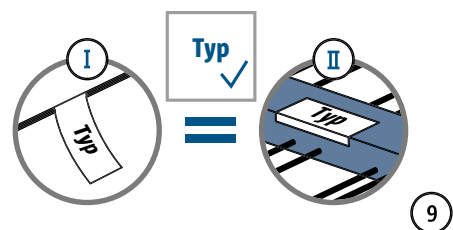
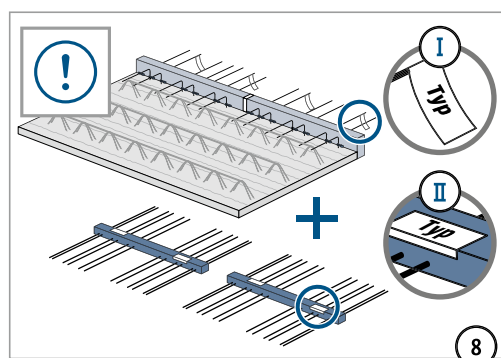
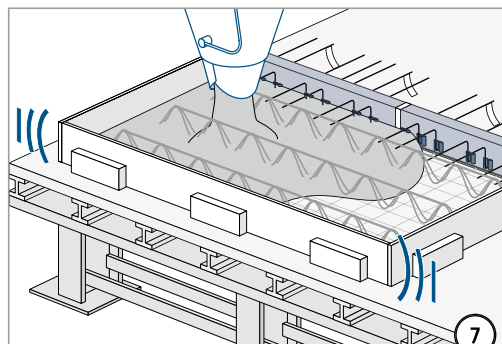
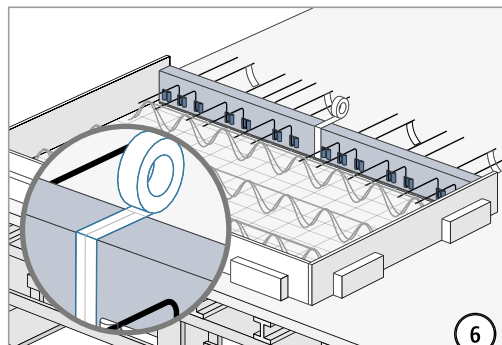
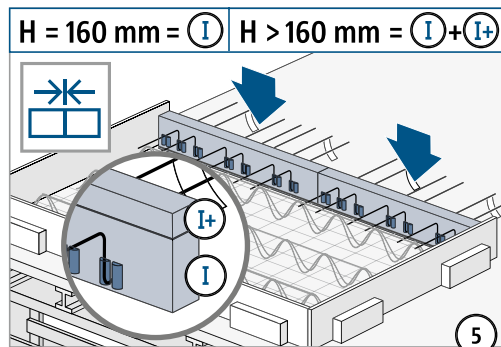
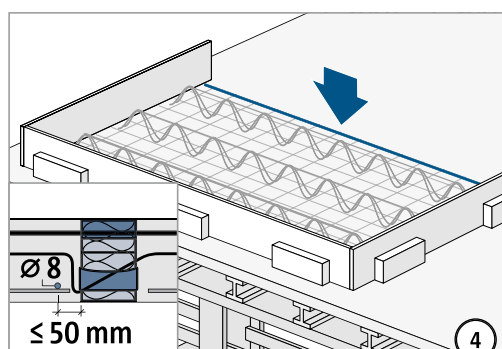
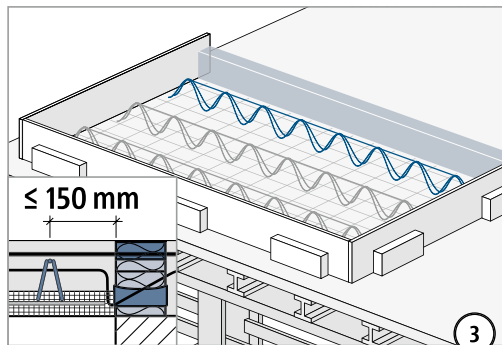

Auf gleiche Typenbezeichnung achten.

Einbauanleitung – Fertigteilwerk

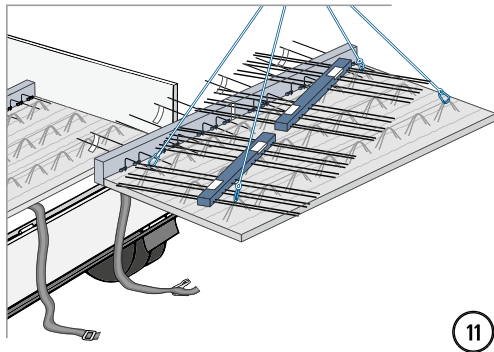
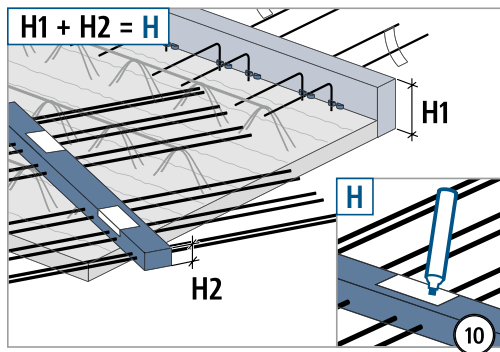

XT/T
Typ K-F

Stahlbeton – Stahlbeton

Einbauanleitung – Fertigteil Baustelle

Typ K-F

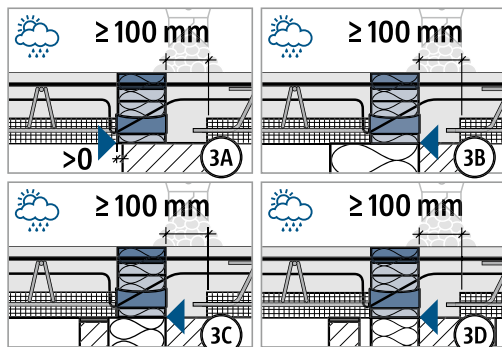
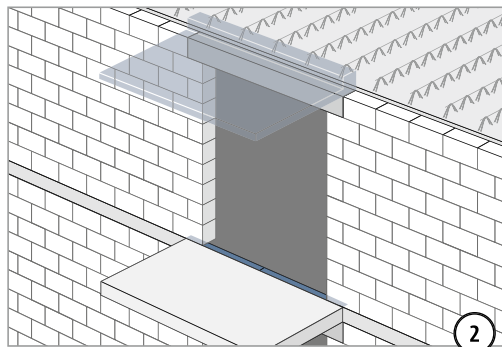
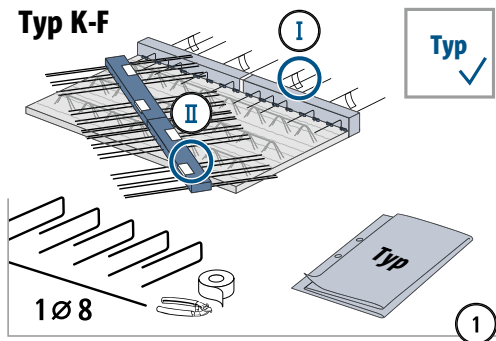

Druckfuge unbedingt mit Ortbeton verfüllen!
Fugenbreite ≥ 100 mm.

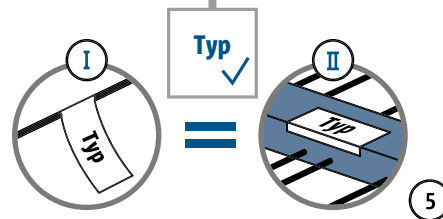
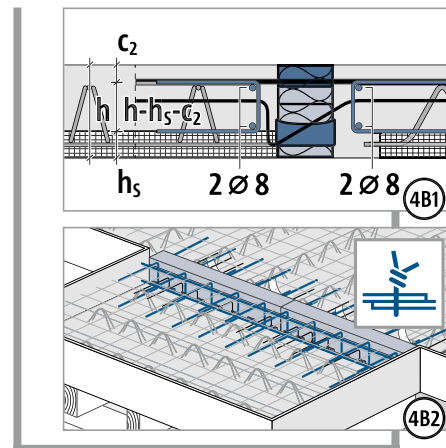
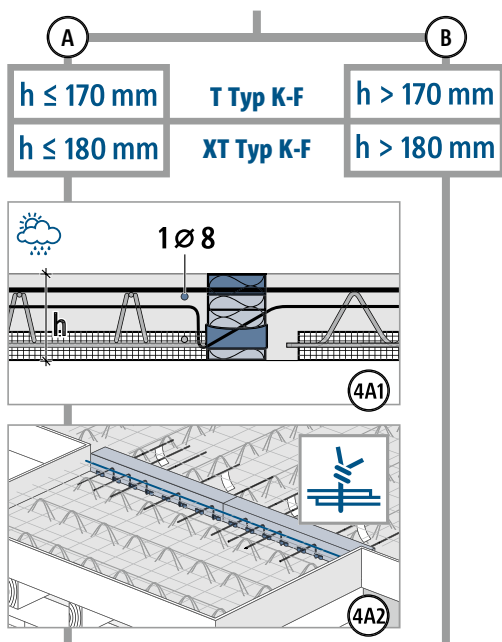

Auf gleiche Typenbezeichnung achten.

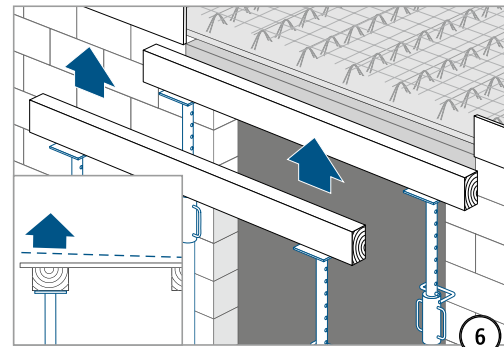

Schalung gemäß Werkplan überhöhen.

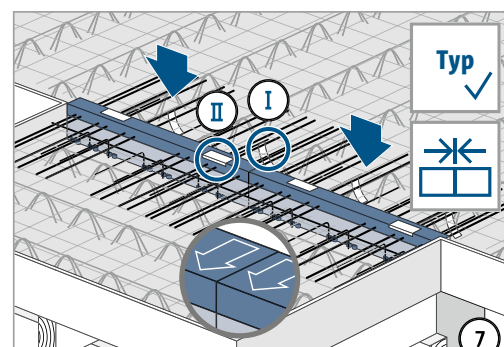

Oberteil ② mit Zugstäben unbedingt einbauen!

Einbauanleitung – Fertigteil Baustelle

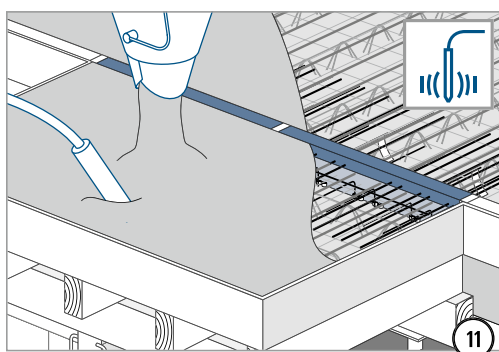
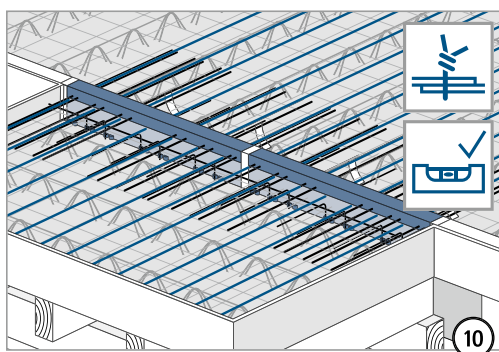
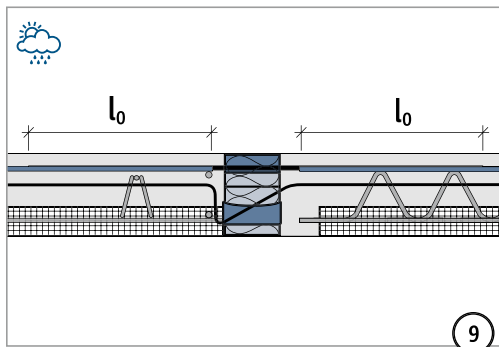
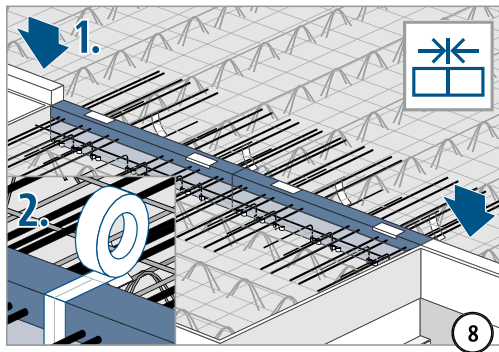
XT/T
Typ K-F

Stahlbeton – Stahlbeton

