

Einbauanleitung – Betonbau

Typ K-B Set FS

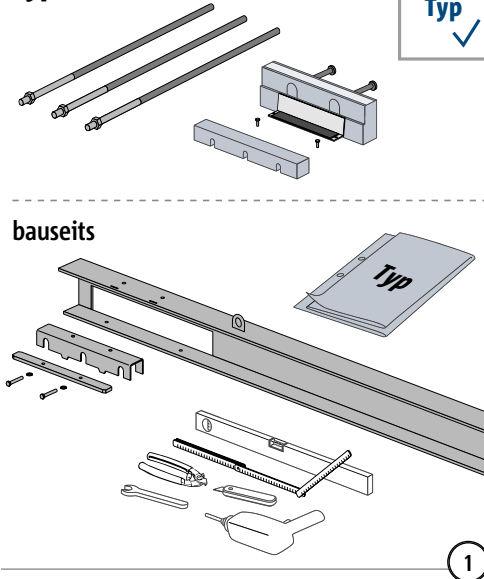

Alle Gewinde auf Leichtgängigkeit prüfen. Falls erforderlich, zuerst säubern und schmieren!

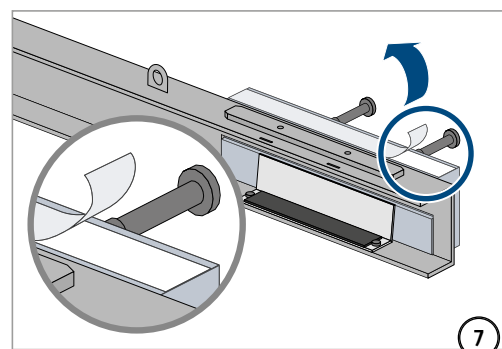
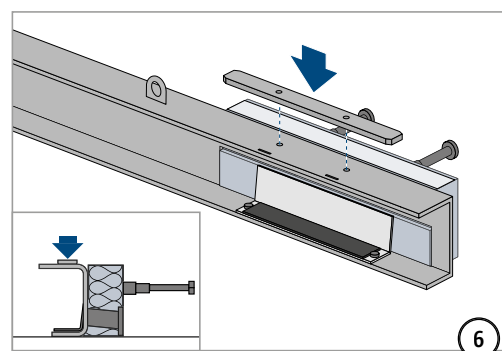
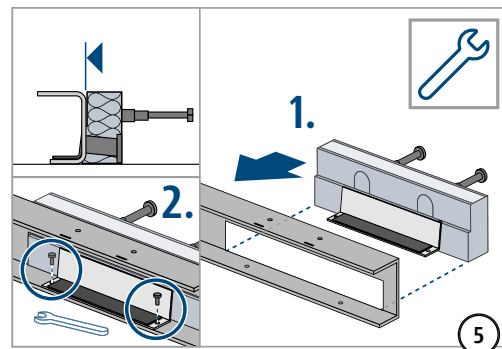
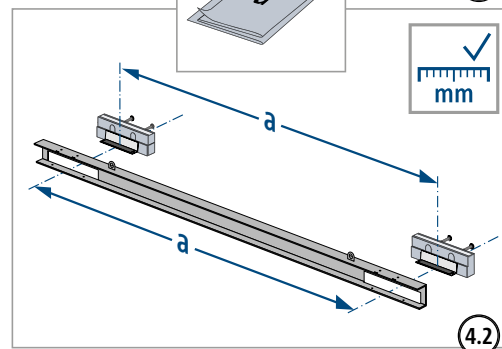
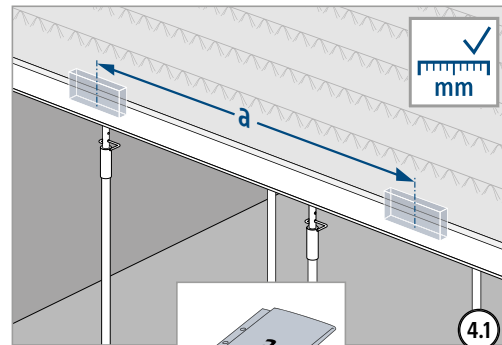
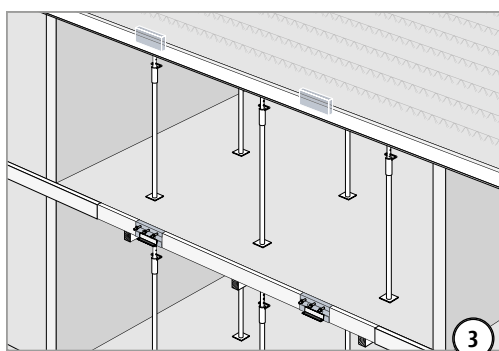
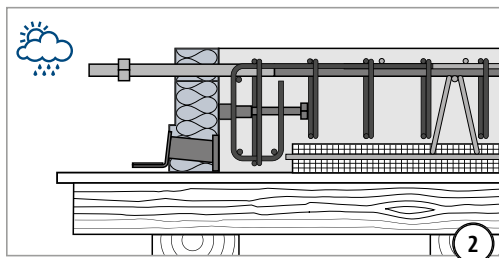

Einbauanleitung – Betonbau

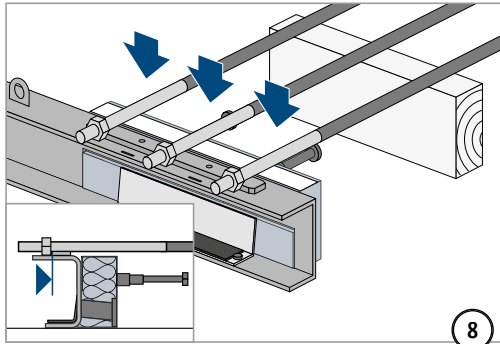

Vor dem Auflegen der Zugstäbe sicherstellen, dass alle Muttern vollständig bis zum inneren Gewindeende aufgedreht sind.

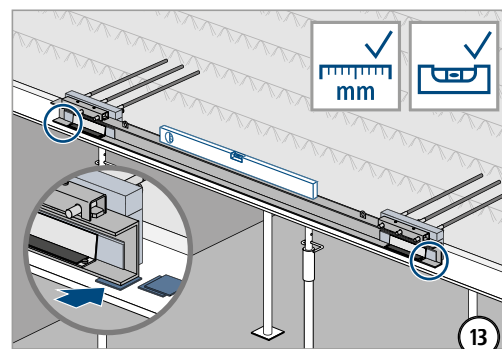
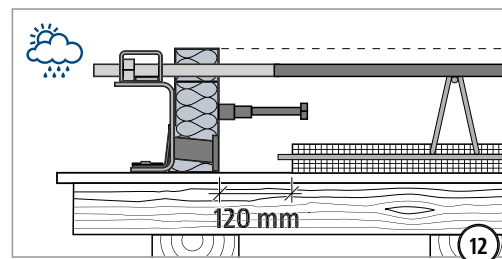
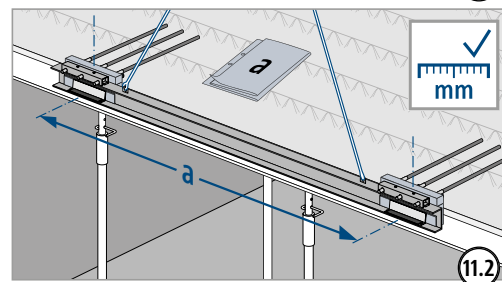
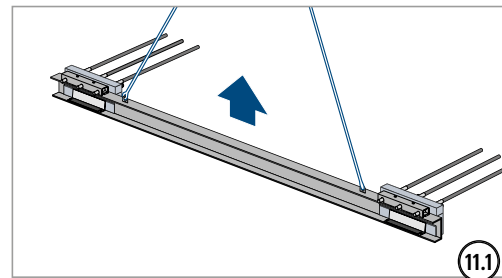
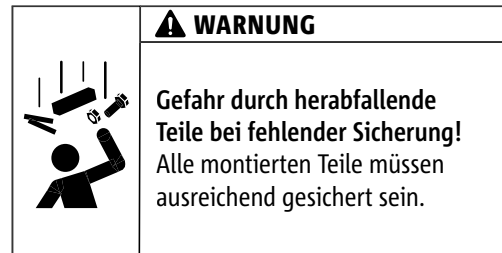
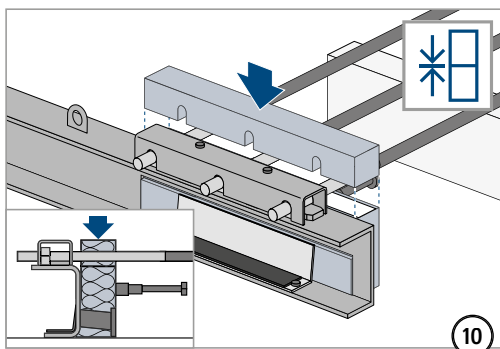
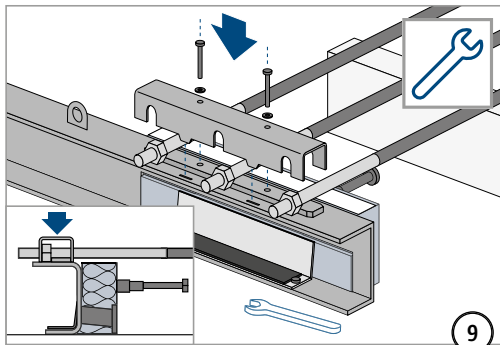

Die Vorspannung des Schalbodens ist gegebenenfalls mit Höhenausgleichsplatten auszugleichen. Dabei muss die korrekte Position des Isokorb® IQ Typ K sichergestellt sein.

Einbauanleitung – Betonbau

