

Einbauanleitung – Betonbau

Typ K-A

Set FS

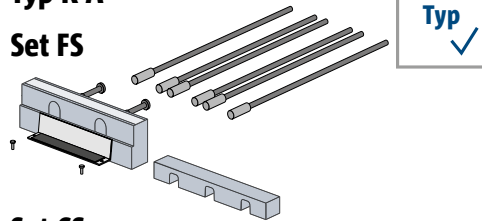

Set CS

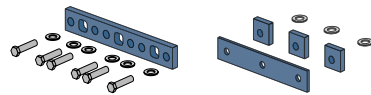

bauseits

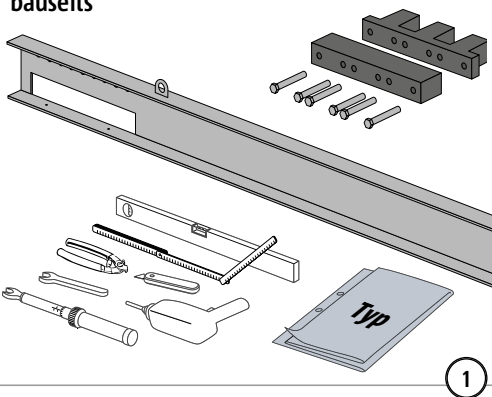

Alle Gewinde auf Leichtgängigkeit prüfen. Falls erforderlich, zuerst säubern und schmieren!

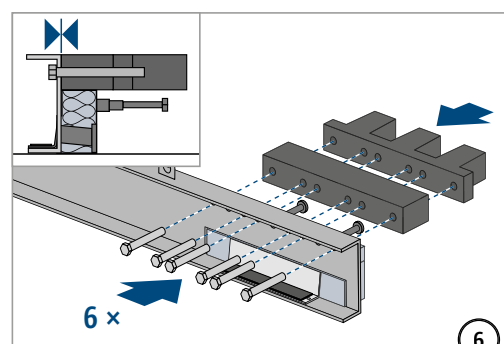
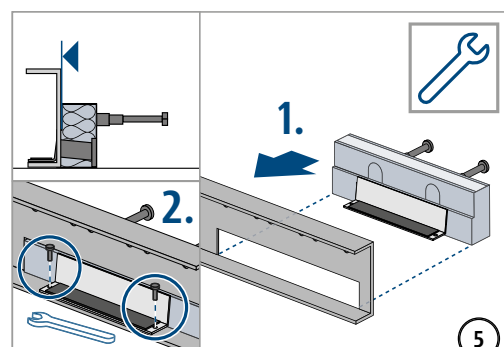
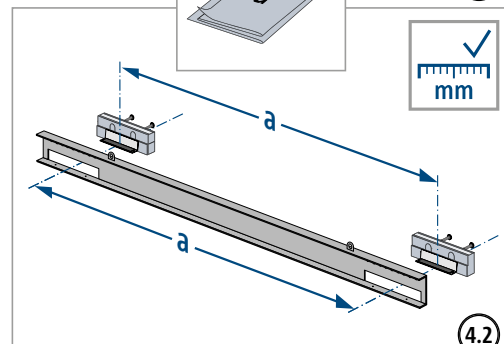
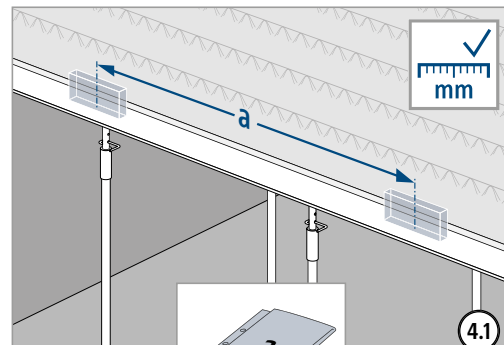
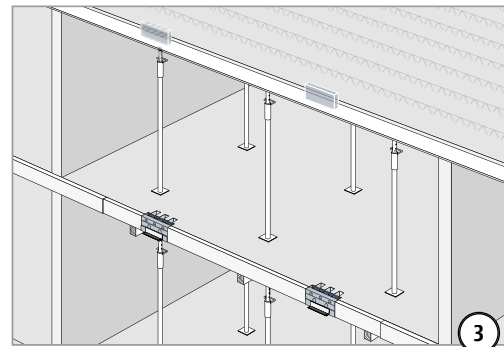
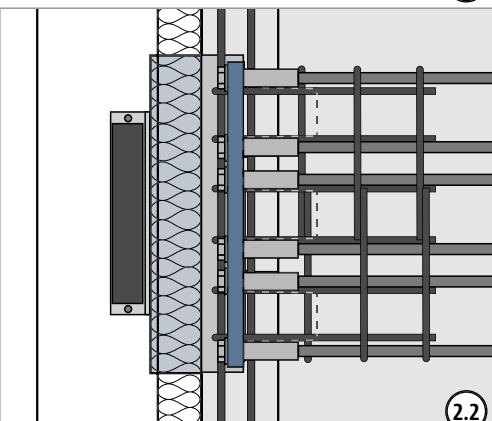
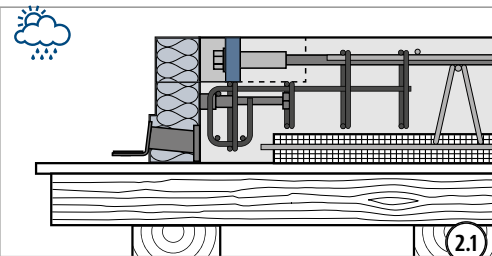

Einbauanleitung – Betonbau

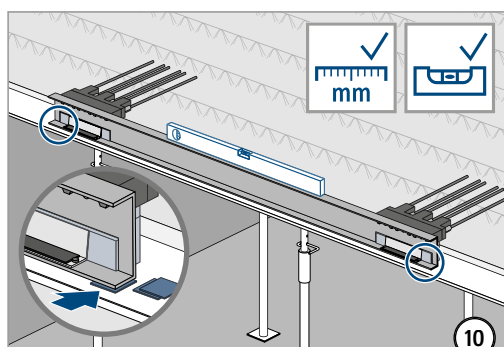
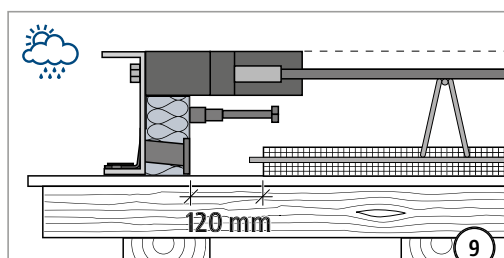
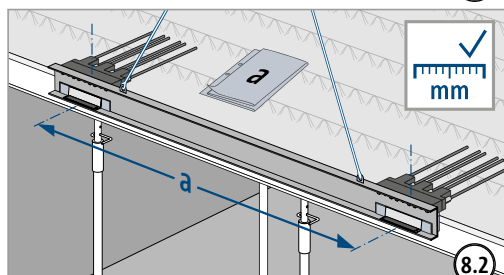
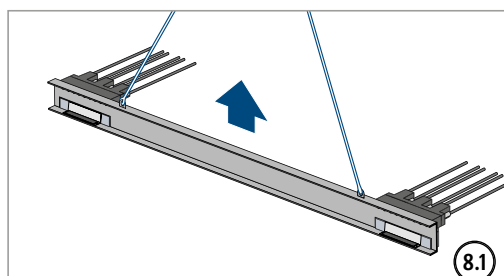
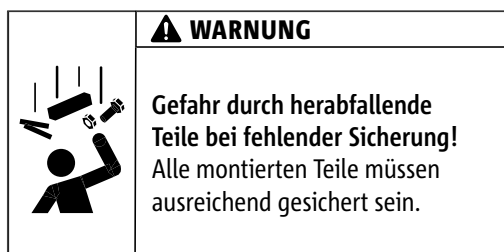
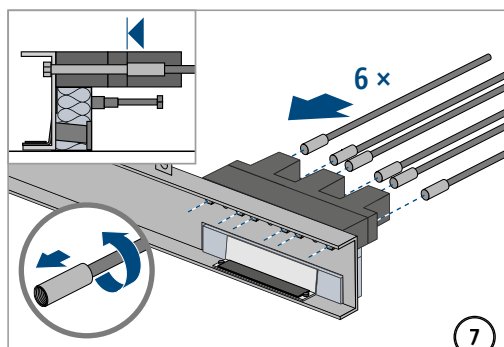

Die Vorspannung des Schalbodens ist gegebenenfalls mit Höhenausgleichsplatten auszugleichen. Dabei muss die korrekte Position des Isokorb® IQ Typ K sichergestellt sein.

$X_1 = 80 \text{ mm}$, $X_2 = 70 \text{ mm}$

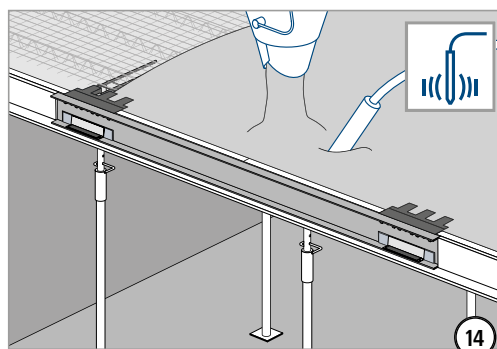
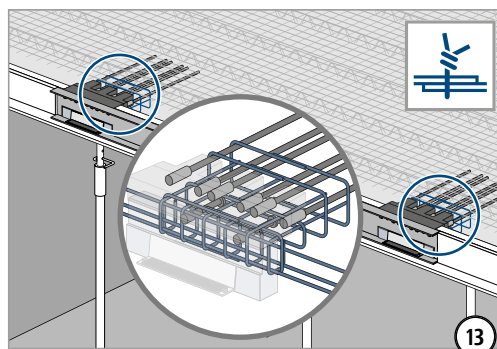
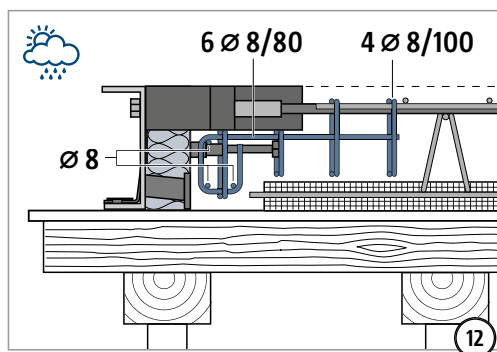
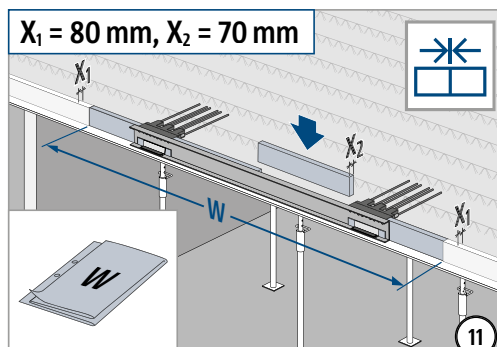

Einbauanleitung – Betonbau

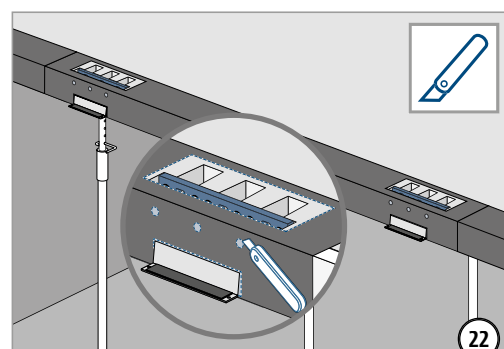
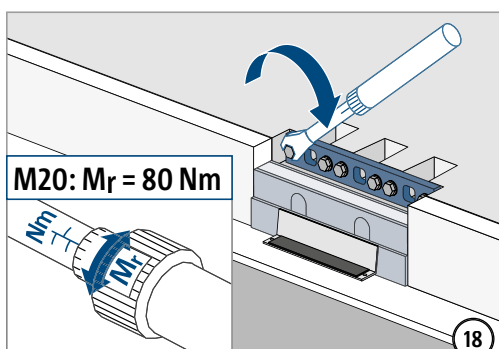
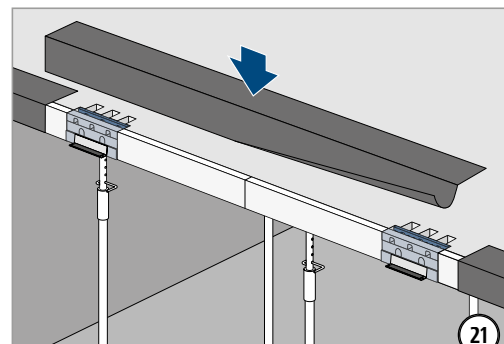
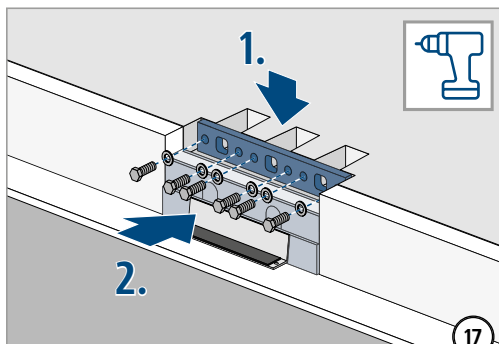
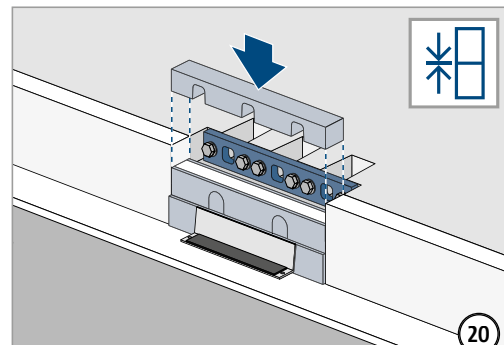
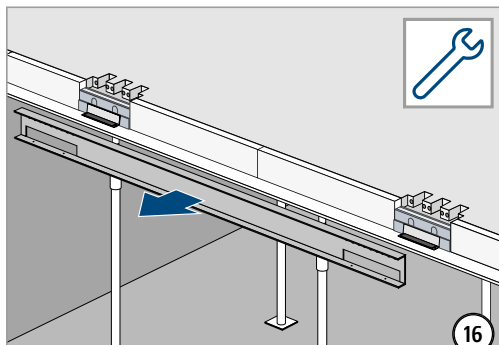
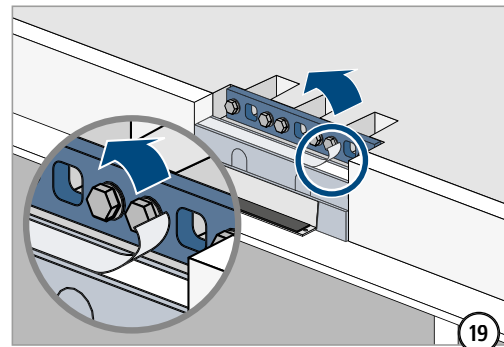
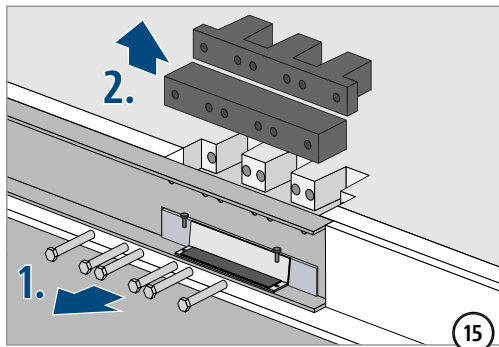

Isokorb® IQ Typ	Gewinde (Zug/Druck)	Schlüsselweite
K-A	M20	30 mm

Typ K-A Set CS

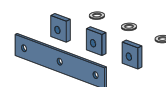

Die verbleibenden Teile von Set CS sind für die Balkonmontage aufzubewahren.