

Thermally separated wall connector

Steel staircase, outside area

Wall with thermal insulation composite system

Detailed view of wall connector | Stair stringer

DCIK 47-01-TW | M 1 : 10

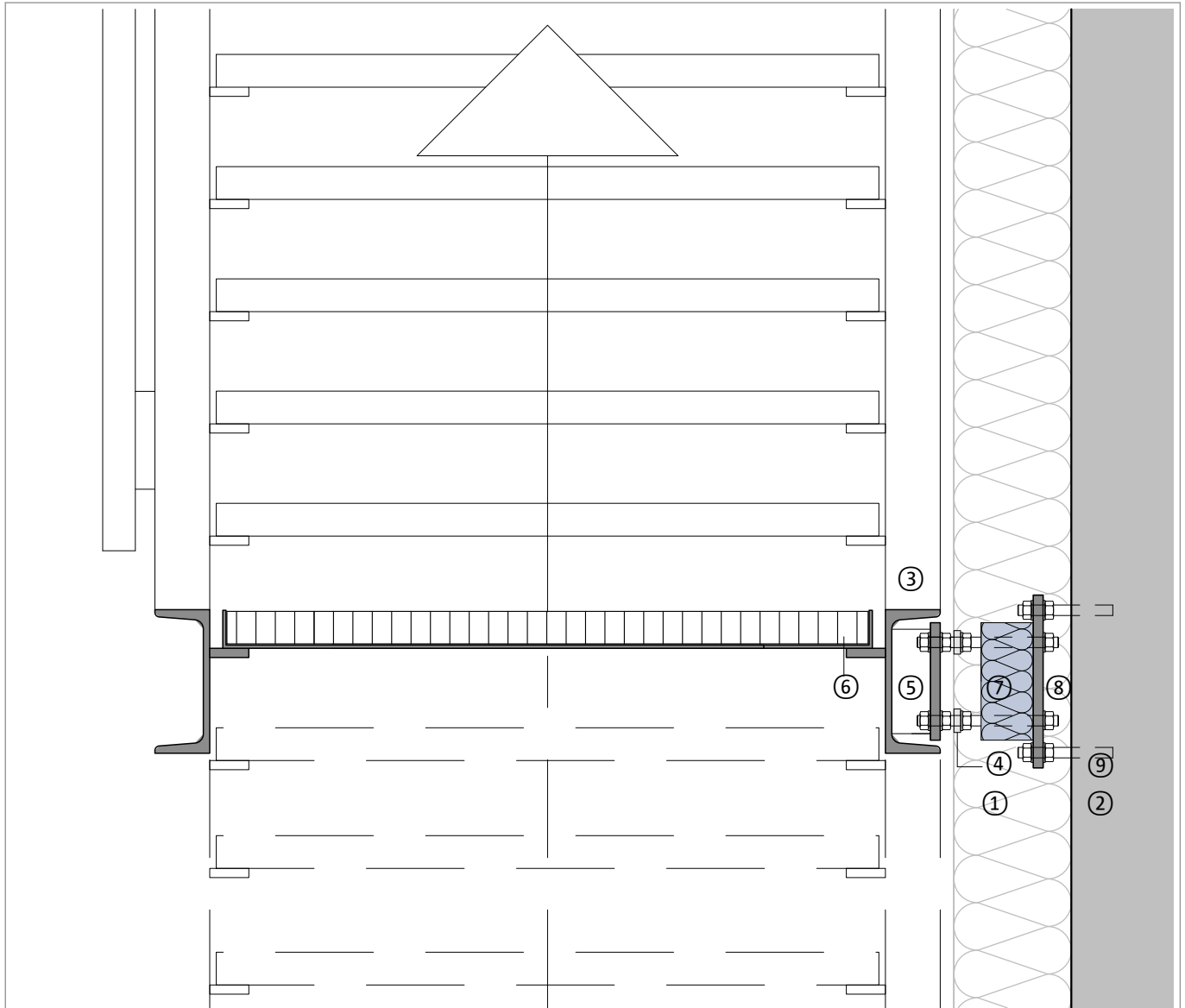

| Component, example | |
|--------------------|---|
| ① | Thermal insulation composite system |
| ② | Reinforced concrete wall |
| ③ | Steel tub, U profile |
| ④ | Plastering profile or elastic connector |
| ⑤ | Head plate with adapter |
| ⑥ | Metal frame, grating |
| ⑦ | Schöck Isokorb® T type S |
| ⑧ | Head plate, stainless steel |
| ⑨ | Glued-in steel anchor |

| Component, example | |
|--------------------|--|
| | |
| | |
| | |
| | |
| | |
| | |
| | |
| | |
| | |

Note: This detailed view is a general, non-binding planning proposal which only provides a schematic overview of the construction work. The planner and processor are responsible for checking applicability and completeness for each construction project. Adjacent components are only shown schematically. All specifications and assumptions must be adapted or coordinated to local conditions. The respective technical specifications of the data sheets, processing guidelines, standards, and system approvals must be observed. Balconies, arcades, and canopies require their own statics.